

## HIGHLIGHTS

- Space for shops
- Planned as per vastu
- Housing loans can be arranged
- Well connected with city buses
- Provision for cable T.V. connections
- Children park and recreation facilities
- On Bombay highway near Hi-tech city
- HUDA and Municipal approved project

## LOCATION MAP

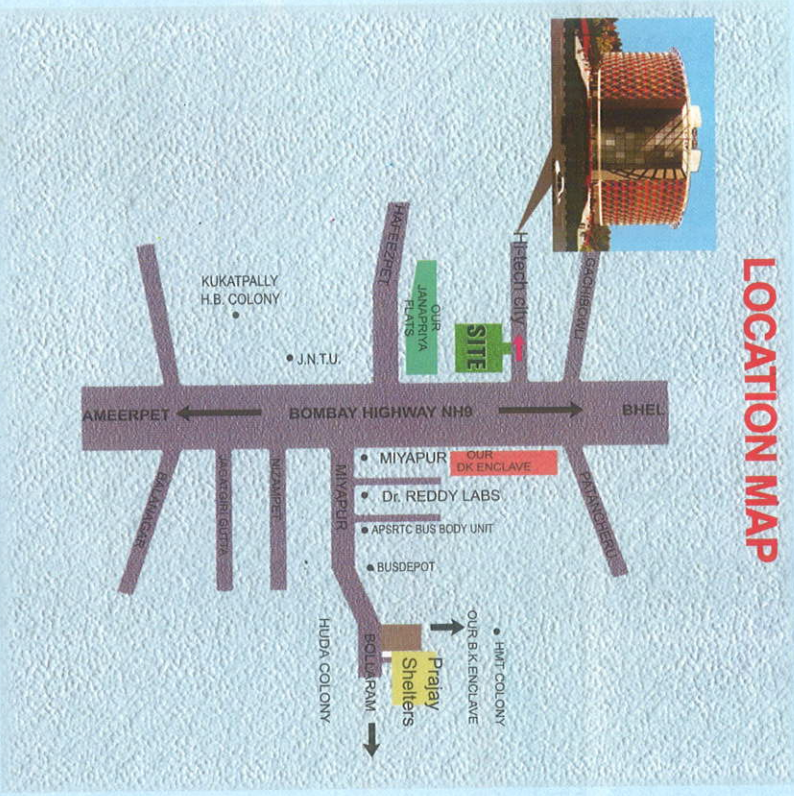

**PRAJAY ENGINEERS SYNDICATE LTD.**

H.O. : 4-1-2/4, Ramkote, Hyderabad. Ph: 4751717 (9 lines)  
 Fax: 4758037  
 Site Ph: 3045564

On Bombay Highway, near Miyapur

# PRAJAY City



**PRAJAY ENGINEERS SYNDICATE**

Ramkote, Hyderabad

# Company Profile

Prajay Engineers Syndicate is a front ranking name in construction with a vast family of satisfied owners in Hyderabad. So far over 4500 units have been sold and scores of projects, including mega townships are in the pipeline. A pioneer of low cost housing for the middle-class, Prajay is a trusted leader with a 13 year old track record of success. It has won the prestigious CTD Awards for three consecutive years in 1994-95, 1995-96 & 1996-97. Breaking away from its image of a low cost builder Prajay has also ventured into luxury farm houses and commercial complexes. Its two highly successful projects- Country Homes and Celebrity Homes (hearing completion) have become the haunt of the higher classes besides setting bench marks in quality. Indexed, Prajay means quality you can afford.



1995 CTD National Gold Award Presented by  
Dr. Madan Mohan Singh  
Union Finance Minister, New Delhi.



The CTD Manavara Award for 1996 by the  
President of India, Dr. Shankar Datt Sharma  
of Rashtrapathi Bhavan, New Delhi.



1997 CTD Award Presented by  
Dr. C. Krishna Rao  
Governor of Andhra Pradesh, Hyderabad.

## కంపెనీ చరిత్ర:

ప్రజయ్ ఇంజనీర్స్ సిండికేట్ - హైదరాబాద్ నగరంలో స్వంత ఇంట్ల గ్రూపులుగా తీర్చిదిద్ది వారి నుండేలో గాడుకట్టుకున్న ఘనత - ఆగ్రగామి గ్రూప్ నిర్మాణ సంస్థవేషణలోకి ఘనము 4500 యూనిట్లు నిర్మించి ప్రజలకు అందించిన మిగిలిన సంస్థ ప్రజయ్. పరెన్ట్ మిగిలిన ప్రజయ్ నైతం నిర్మిస్తోంది. తక్కువ ఖర్చుతో అత్యుత్తమ నాణ్యతాపూర్వక గ్రూప్ నిర్మాణంలో ఆగ్రగామిగా, మధ్య తరగతి వారి కలలు నండేండ్ అవుదాన మిటేడిగా ప్రజయ్ 13 సం.ల సుదీర్ఘ చరిత్రలో నాధుంచిన విజయాలు కోకోలు. ప్రతిష్టాత్మక CITD అవార్డును వరుసగా 1994-95, 1995-96, 1996-97 సంవత్సరములలో మూడు సార్లు గెలుచుకుంది. కేవలం తక్కువ ఖర్చు గ్రూప్ నే కాక లగ్జరీ హోమ్స్ను, కమర్షియల్ కంప్లెక్స్లను నైతం నిర్మించి కొత్త రూపం దాల్చింది. ఆ రెండు ప్రతిష్టాత్మక ప్రాజెక్టులు - కంట్రీ హోమ్స్ మరియు సెలెబ్రిటీ హోమ్స్ ఈ ప్రాజెక్టులు ఉన్నత స్థాయి వర్గాల వారి విశేషంగా ఆకర్షిస్తూ, నాణ్యతకు గీటురాళ్ళుగా ఉత్తమ కట్టడాలకు ఉదాహరణలుగా నిలుస్తున్నారు. అంతేకాదు - ప్రజయ్ అంటే అత్యుత్తమ నాణ్యత, ఉదాహరణలుగా నిలుస్తున్నాయి. అందుబాటులో అందరూ నమ్మే, మెచ్చే తక్కువ ధరలో అవుదాన కట్టడాలు.

Details of Flat & Position	Cost for Sft. in Rs.	Initial Advance	Total Cost of the Flat	Details of Flat & Position	Cost for Sft. in Rs.	Initial Advance
Type I 665 Sft. (Corner Type) (D.B.R.)	G. F. 425 F. F. 425 S. F. 425 T. F. 425 F. F. 410	18,000 18,000 18,000 18,000 18,000	2,91,125 2,91,125 2,91,125 2,91,125 2,80,850	Type IV 530 Sft. (Middle Type) (D.B.R.)	G. F. 400 F. F. 400 S. F. 400 T. F. 400 F. F. 385	18,000 18,000 18,000 18,000 18,000
Type II 565 Sft. (Corner Type) (D.B.R.)	G. F. 425 F. F. 425 S. F. 425 T. F. 425 F. F. 410	18,000 18,000 18,000 18,000 18,000	2,40,125 2,40,125 2,40,125 2,40,125 2,31,650	Type V 500 Sft. (Middle Type) (D.B.R.)	G. F. 400 F. F. 400 S. F. 400 T. F. 400 F. F. 385	18,000 18,000 18,000 18,000 18,000
Type III 565 Sft. (Middle Type) (D.B.R.)	G. F. 400 F. F. 400 S. F. 400 T. F. 400 F. F. 385	18,000 18,000 18,000 18,000 18,000	2,26,000 2,26,000 2,26,000 2,26,000 2,17,525	Type VI 375 Sft. (Middle Type) (S.B.R.)	G. F. 400 F. F. 400 S. F. 400 T. F. 400 F. F. 385	18,000 18,000 18,000 18,000 18,000

### SPECIFICATIONS :

● Blocks with lift- 3rd floor rate will be same as 2nd floor. 4th floor rate will be Rs. 15/- less per sq. ft. from 3rd floor. ● The above rates are liable to change ● Measurements may change during construction and the price will change accordingly.

**For Ground Floor and First J Rs. 26/- per S.F.T Extra. w.e.**

<b>Foundation</b>	RCC Footing in (1:2:4) Mix
<b>Basement</b>	CRS in CM (1:8) Mix
<b>Structure</b> (Columns / Beams / Footings)	RCC (1:2:4) Mix
<b>Walls</b>	4"/3" Hollow Cement Blocks (1:1:12) Mix
<b>Plastering</b>	Internal : Single Coat Towel Finish in Composite Mix (1:1:12) External : Two coats sponge finish in (1:6)
<b>Doors</b>	Wooden frames with flush Shutters
<b>Windows</b>	Steel windows with safety bars and glass paneling
<b>Flooring</b>	Grey Mosaic
<b>Electrical</b>	Al. wiring with minimum 12 - Maximum 15 Light and Fan points with 1 power flooring in smooth kalai finish. Walls with Red oxide up to 4 feet height, with in
<b>Toilets</b>	Two Coats of White wash
<b>Colouring</b>	Internal : External : Doors & Windows : Enamel
<b>Kitchen</b>	Cooking platform in polished Cuddapah stone with Mosaic Sink.
<b>Common Areas</b>	Cement Kalai finish with suitable railing

### MODIFICATIONS / ALTERATIONS ALLOWED ON EXTRA COST

1. Ceramic/ Glazed Tiles in Toilets up to 4 ft. / 5 ft. Height & over kitchen Platform up to 2 ft. height in Bedroom
  3. Storage Locks
  4. OBD Painting any two colour decided by management
  5. Show Geyser provision in Toilets
  6. Showcase and RCC shelves in Hall
  7. Extra Electrical Points / Power
- Note : Compulsory Scooter Parking at Extra Cost.
- This Brochure is only a conceptual presentation and not a legal offering. The management reserves the right to change any/ all of the specifications.

### COMPLETED PROJECTS

HUDA Complex	-	Saroonnagar
Karol Bagh Apartments	-	Mehdipatnam
Janapriya Homes	-	Vanastalipuram
Karthik Apartments	-	Ramnagar
Diamond Towers	-	Nallakunta
Ketan Apartments	-	Begumpet
Dattatreya Apartments	-	Asifnagar
Janapriya Apts. Phase - I	-	Miyapur
Rukmini Apartments	-	Yousufguda
E. S. Apartments	-	Madhuranagar
Vidya Vihar Apts.	-	Vidyanagar
Dantapalli Chambers	-	Barkatpura
Moonrock Apartments	-	Masabtank
Radha Devi Apartments	-	Ramanthapur
N. B. Residency	-	Narayanguda
Pioneer Chambers	-	Hyderguda
Sarojini Chambers	-	Chikkadpally
Janapriya Apts. Phase-II	-	Miyapur
D. K. Enclave	-	Miyapur
Hidden Treasure Apts.	-	Somajiguda
Prajay Ashray	-	Uppal

### PRESENT PROJECTS

Prajay Majestic	-	Chadharghat
Jatkar Bhavan	-	Chikkadpally
Prajay Avenue I & II	-	Amberpet
Munawar Chambers	-	Somajiguda
Prajay Banjara	-	Banjara Hills
Celebrity Homes	-	Shamirpet
Retreat Point	-	Sec'bad
Prajay Alkapuri	-	R. K. Puram
Prajay Corporate Plaza	-	Begumpet
Prajay Crest	-	S. D. Road
Prajay Nivasa - I	-	Mohan Nagar
Prajay Nivasa - II	-	Mohan Nagar
Prajay Gruhatara	-	Kompally
Prajay Mall	-	Gowliguda
Prajay City	-	Hafeez pet
Prajay Shelters	-	Miyapur
B. K. Enclave	-	Miyapur
Country Homes - I	-	Shamirpet
Country Homes- II	-	Shamirper

## TYPICAL FLOOR PLAN 1



Plan not to scale.

## TYPICAL FLOOR PLAN 2

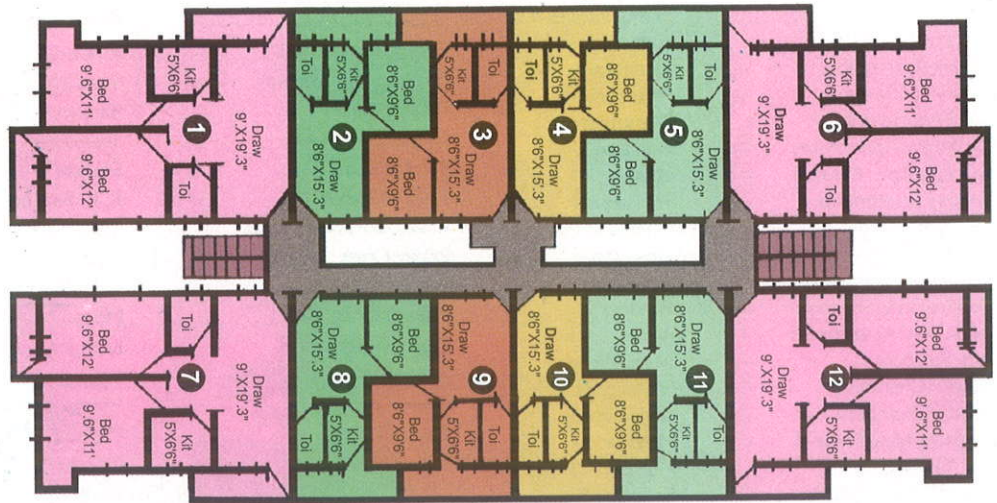

Plan not to scale.

685 sft

350 sft

350 sft

350 sft

350 sft

685 sft

## TYPICAL FLOOR PLAN 3

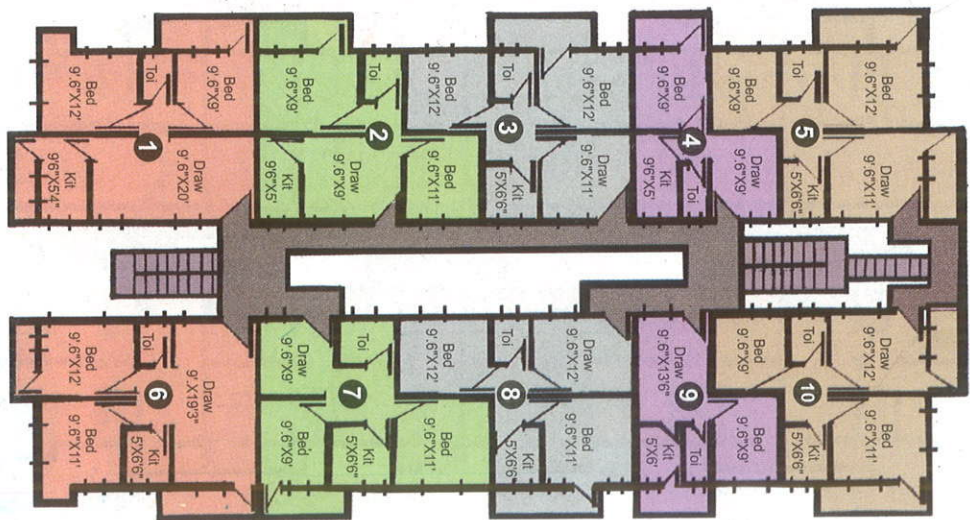

Plan not to scale.

685 sft

500 sft

565 sft

375 sft

565 sft

All measurements to be converted into Sq. Mtrs.